

Test – Statically Determinate Structures

Given the statically determinate structures represented in figures determine:

1. The external and internal reaction forces;
2. The scale diagrams of Bending Moment, Shearing Force and Axial Force (Exercise 4 requires only the Axial force to be demonstrated for each single beam element);
3. The horizontal displacement in E (Exercise 3) and vertical displacement in A (Exercise 2);

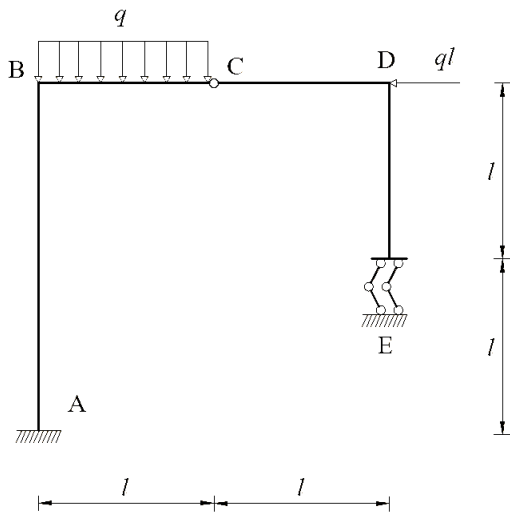

Figure 1 (Exercise 1)

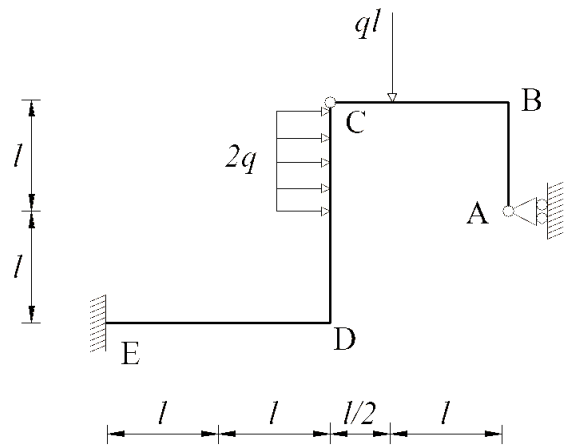

Figure 2 (Exercise 2)

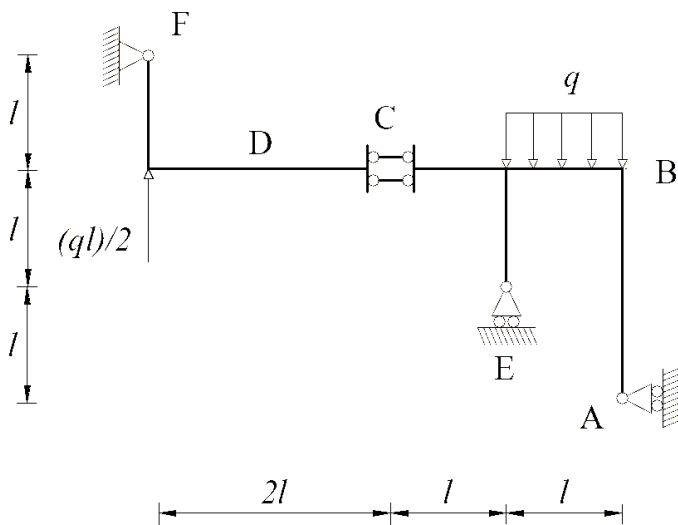

Figure 3 (Exercise 3)

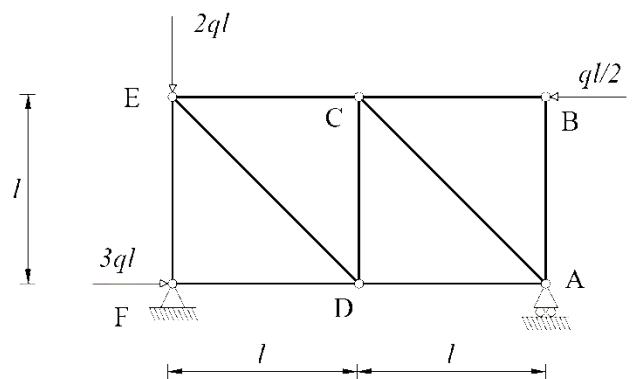

Figure 4 (Exercise 4)